

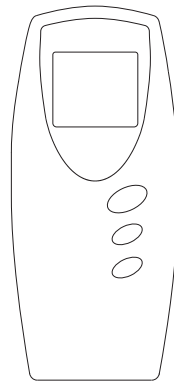

DT-F1/DT-F1V



GB

Revision 1



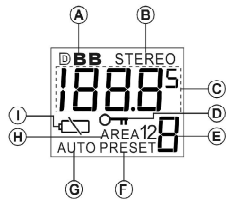
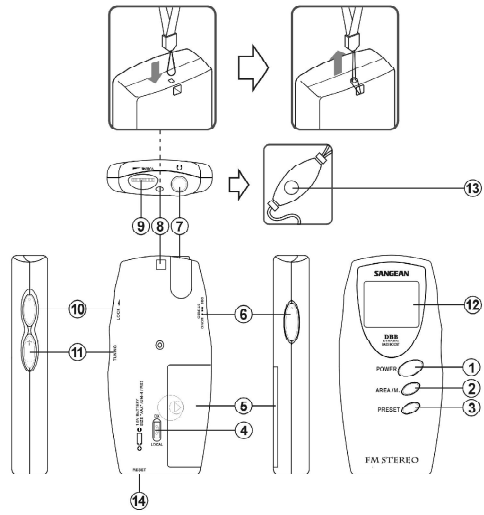



Controls

- ① Power button (also as FM/TV band selector on DT-F1V)
- ② Memory and preset area selection button
- ③ Preset button
- ④ DX/Local selection switch
- ⑤ Battery compartment **GB**
- ⑥ Stereo/mono/DBB selection switch
- ⑦ Earphones Jack ⑧ Neck strap holder
- ⑨ Volume control ⑩ Lock switch
- ⑪ Tuning UP/DOWN ⑫ Display
- ⑬ Remote control on Preset up and Power on/off (located on the supplied earphones)
- ⑭ RESET button

Display

- Ⓐ DBB indicator (Dynamic Bass Booster)
- Ⓑ Stereo indicator Ⓒ Frequency display
- Ⓓ Lock indicator
- Ⓔ Memory preset indicator
- Ⓕ Preset Ⓖ Auto preset
- Ⓖ Preset area Ⓗ Low battery indicator



Batteries

Open the battery cover located on the rear of the set by sliding it in the direction shown by the mark. Insert one AAA (UM-4) size battery into the compartment. Ensure that battery is inserted in accordance with the diagram shown alongside the battery indicator .

Note: Battery should be replaced when the low battery indicator  appears in the display.

During battery replacement ensure that the radio is turned off and the Lock switch is in the lock position, this will prevent loss of memory presets during battery replacement. Battery replacement should be completed within one minute to prevent loss of stations stored in memory presets.

If the radio is not to be used for long period, set the Lock switch to Lock position, this will reduce power drain on the batteries during storage.





Addendum

GB

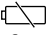
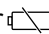

Note and Important:

The low battery indicator  appears to remind you to be ready for battery replacement. The radio can still last for another 6-10 hours or even more depending on the types of batteries used, replace the batteries when the low battery indicator  is flashing.



Lock switch

The Lock switch is used to prevent unintentional operation of the radio. Set the Lock switch located on the right side of the radio to the Lock position. The power and all other buttons will be disabled, this will prevent accidental operation when the radio **GB** is packed in a suitcase or travel bag.

To prevent accidental operation of the controls when the radio is switched on, set the Lock switch to the Lock position, the  symbol will appear in the display. To release the Lock switch, move the lock switch to the down (unlock) position, the  symbol will be removed from the display.

Earphones

Plug the earphones supplied into the earphones jack located on the top of the radio.

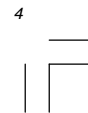





Antenna

The lead connecting earphones to the set also acts as an FM antenna when plugged into the earphones jack. The lead should be extended as much as possible to increase the reception.

Radio Operation

Auto Preset

When the battery is inserted into the battery compartment for the first time, with earphones plugged in, the radio will quickly and automatically set all your memory based upon the signal strength of the incoming stations, display will flash AUTO PRESET. Among the many conveniences offered by this feature, it is especially useful for the traveler who can automatically find all the local stations in any strange city he may travel to. The radio will turn off automatically after Auto Preset is done. Up to 9 stations can be stored on Preset area 1.



You may also activate the Auto Preset anytime when the radio is turned on by pressing tuning Up/Down buttons at the same time for more than 2.5 seconds.

Note: Activating the Auto Preset function will overwrite any stations previously stored in the memory presets.

Turn on the radio

GB

Turn on the radio by pressing the Power button for more than 0.7 second. Or press the remote button on the supplied earphones for more than 1.5 second to turn the radio on.

Note: for DT-F1V Northern America, after turning on the radio to select the FM or TV band by pressing the power button again for less than 0.7 second, pressing the power button for more than 0.7 second will turn off the radio.

Turn off the radio

Turn off the radio by pressing the Power button for more than 0.7 second when radio is on or press the earphones remote button for more than 1.5 second to turn the radio off.



Scan tuning

Turn on the radio, press and hold down the Tuning up or Tuning down button for more than half a second and release the button to commence scan tuning. The radio will scan and stop automatically when a station is found.

Press and hold down either the Tuning up or tuning down buttons for more than half a second to resume scan tuning.

Manual tuning

Turn on the radio by pressing the Power button for more than 0.7 second. The desired station may be selected by repeatedly pressing the Tuning up or Tuning down button until station of your choice is reached.





Storing stations in preset memory

There are 9 preset memories each on area 1 and area 2 (like page 1 and page 2 on some of car stereo receivers) in total 18 preset memories for this radio.

Turn on the radio, tune to the desired stations using scan and manual tuning as previously described. Press the Memory button (AREA/M.) 2, the display will flash Preset, press PRESET button 3 to select memory position then press AREA/M again to complete the memory preset. **GB**

To change PRESET area from area 1 to area 2 and vice versa, press AREA/M for more than 3 seconds, display AREA will flash the change, continue pressing for another 2 seconds until flash stops. The Preset area now is changed (from Area 1 to Area 2 and vice versa).



Recalling the stations from preset memories

Turn on the radio, press PRESET button to select the required preset memory stations. Same way to change PRESET area as described above on storing stations in preset memories.

Pressing remote control button on the supplied earphones for less than 1.5 seconds can also recall the preset stations.

(Note: pressing remote control button more than 1.5 second will turn off the radio)

Mono/Stereo/DBB(Dynamic Bass Boost) switch

If the station being received is weak some hiss may be audible, to reduce the hiss, switch the button to mono mode, the stereo indicator will be removed from the display.

Setting the switch to DBB will enhance bass sounds, display will show both DBB and STEREO. However both AM (MW) and TV sound (DT-F1V only) are mono, display won't show STEREO.



Auto power off

In order to save battery power, the radio is designed to automatically switch off after 90 minutes of use. Disconnect the earphones from earphones jack for more 10 seconds will also turn off the power automatically.

GB

DX/Local switch

When you listen to a strong station and the signal is slightly distorted, set the switch to the LOCAL position for best reception. For normal or weak stations, set the switch to the DX position for maximum sensitivity.





RESET button

If the radio fails to operate correctly, or some digits on the display are missing or incomplete, carry out the following procedures .

1. Switch off the radio and remove the batteries.
2. With the aid of a suitable implement (the end of a paper clip or pen). Press the RESET button located in the bottom of the radio for at least 5 seconds, this will reset the microprocessor and clear all stations stored in the preset memories.

Specifications

Battery: 1 x AAA (LR03,UM-4)

Battery life:
Approx. 30 hours using alkaline batteries

Frequency coverage:
FM 87.50 - 108 MHz
TV 2 - 13 channels (DT-F1V only)

Output Power: 0.5 mW

Earphones Jack: 3.5 mm dia (stereo)

The company reserves the right to amend the specifications without notice.